

USERS GUIDE

SAND SPREADER

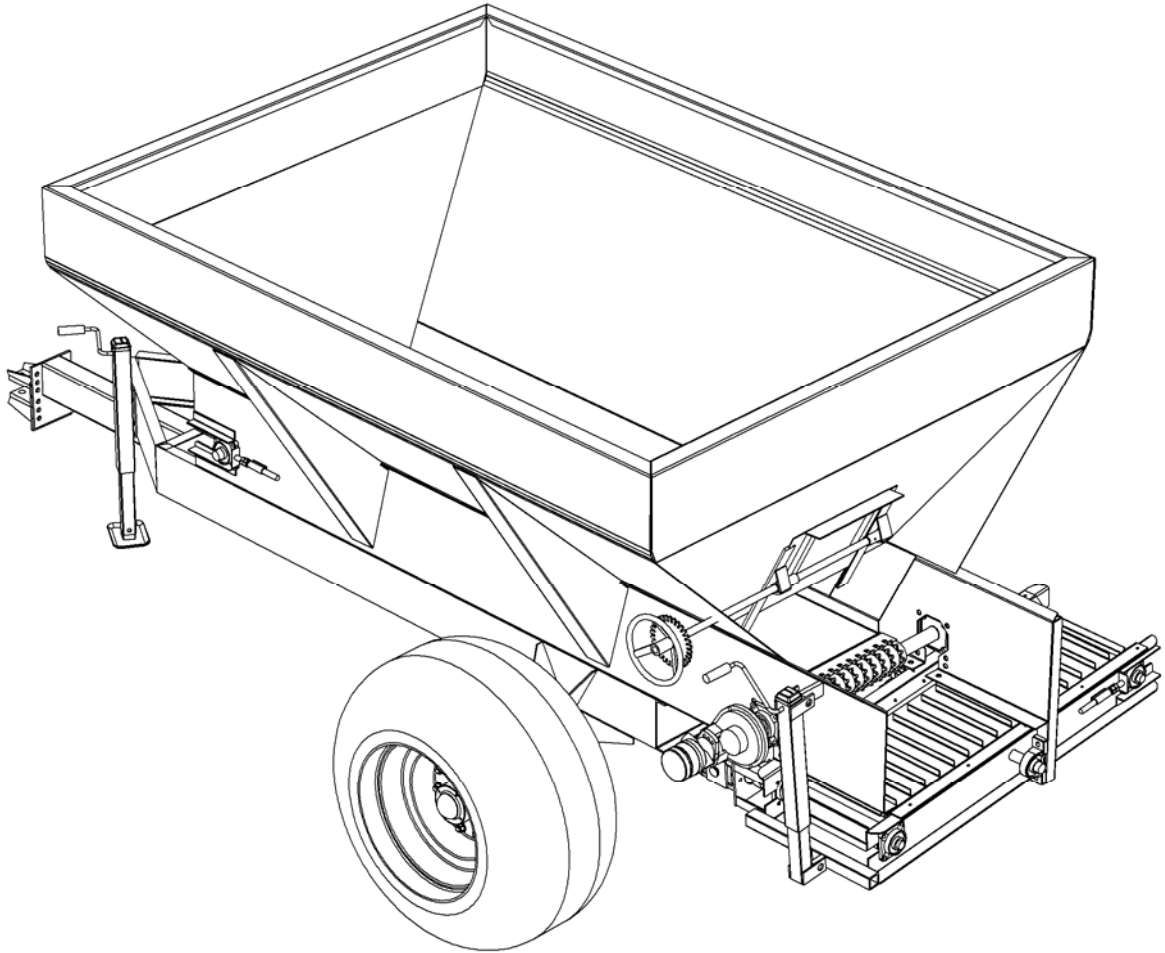

BARRON & BROTHERS INTERNATIONAL

706-778-2767
800-282-3570

470 S. WAYSIDE ST.
P.O. BOX 630
CORNELIA, GA 30531

**TABLE OF
CONTENTS**

USERS GUIDE – BBI SAND SPREADER

TO OUR CUSTOMERS	3
WARRANTY	4
SAFETY	5
OPERATION	7
HYDRAULIC SYSTEM	8
HYDRAULIC CONTROLS	9
SIDE CONVEYOR	10
MAINTENANCE	11

TO OUR CUSTOMERS

The BBI team takes pride in producing superior spreaders that will provide many years of service. Components are selected for their proven performance record and availability. Our skilled employees give special attention to detail in design and assembly to make certain our equipment will meet or exceed your expectations.

Our parts department stands ready to serve you with replacement parts at affordable prices. We stock a large inventory to assure support for our customers, and take pride in offering “same day service” for those orders received before mid-afternoon.

At BBI, we provide quality service with a friendly atmosphere. Our dealers can offer service assistance, or we can be contacted directly. We strive to quickly provide solutions for your needs in order to minimize any downtime or delays.

At BBI we take safety very seriously. Great concern is given to reduce any potential safety issues, whether with equipment or in the work place. Our equipment is designed to minimize pinch points and provide guards where they do exist. Decals are placed on our equipment to identify and caution against areas of pinch points and hazardous moving parts. Please be sure that those who operate BBI equipment are properly trained. *Never conduct maintenance or repairs unless the equipment is fully disabled with the power source turned off. Never stand inside the unit while in operation or moving.* Our spreaders are designed to project materials from 30 to 90 feet, depending on the specific equipment; and *standing too close can result in injury. Please use extreme caution when operating all farm equipment.*

Thank you for choosing BBI spreading equipment. You will be glad you did.

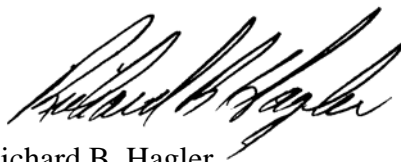

Richard B. Hagler
President

“Spreaders That Work as Hard as You Do”

WARRANTY

Barron & Brothers International warrants all products manufactured by it to be free from defects in material and manufacturing at the time of shipment AND for an additional period of One Hundred Eighty (180) days, from the date invoiced to our direct customer or the dealer's customer AND provided the total period does not EXCEED One (1) Year from the date invoiced to the dealer. On parts manufactured by another vendor (i.e., motors, pumps, axles, etc.), the parts will be subject to the original manufacturer's warranty AFTER expiration of Barron & Brothers International's One Hundred Eighty Day (180) Warranty.

Barron & Brothers International's warranty SHALL BE VOID AND NOT APPLY to any product which has been subject to misuse (including but not limited to overloading), misapplication, neglect (including but not limited to improper maintenance), accident, improper installation of parts, modification of the unit, improper adjustment, or improper repair of the unit. All parts to be warranted by Barron & Brothers International must be returned to the factory for inspection and final disposition.

NOTE: THE PART ON QUESTION MUST BE RETURNED WITHIN 30 DAYS FOR CREDIT TO BE ISSUED!!

Barron & Brothers International's liability for its equipment, whether due to breach of warranty, negligence, strict liability, or otherwise, is LIMITED to providing a replacement part(s) in exchange for the defective part(s) AND Barron & Brothers International will not be liable for any injury, loss, damage, or expense, whether direct or consequential, including but not limited to loss of use, income, profit, or production, OR the increased cost of operation.

PARTS

Use only genuine Barron & Brothers International Parts!
Order them from the *Authorized Dealer* in your area.

When placing an order, please have available:

1. The pertinent model and serial number of the spreader.
2. The part name, part number, and the quantity required.
3. The correct street address to where the parts are to be shipped and the carrier if there is a preference.

SHIPPING DAMAGES

Claims for shortages or errors must be made immediately upon receipt of goods. When broken or damaged goods are received, a full description of the damage must be made to the carrier agent on the freight bill. If this is insisted upon, full damage can always be collected from the transportation company. Please contact BBI as soon as possible after carrier is notified.

If your claims are not being handled by the transportation company to your satisfaction, please contact our Customer Service Department at 1-800-282-3570 for assistance.

SAFETY

ACCIDENTS

Most accidents, whether they occur in industry, on the farm, at home, or on the highway, are caused by the failure of an individual to follow simple and fundamental safety rules and precautions. For this reason, most accidents can be prevented by recognizing the real cause and doing something about it before the accident occurs.

Regardless of the care used in the design and construction of any type of equipment, there are many conditions that cannot be completely safeguarded against without interfering with reasonable accessibility and efficient operation.

A CAREFUL OPERATOR IS THE BEST INSURANCE AGAINST AN ACCIDENT. THE COMPLETE OBSERVANCE OF ONE SIMPLE RULE WOULD PREVENT THOUSANDS OF SERIOUS INJURIES EACH YEAR. THAT RULE IS:

NEVER CLEAN, OIL, OR ADJUST A MACHINE WHILE IT IS UNDER POWER.

National Safety Council

CAUTION!



If the spreader is used to transport chemicals, check with your chemical supplier regarding the DOT (Department of Transportation) regulations.

SAFETY DECALS



SAFETY



- Refrain from wearing loose fitting clothing on or around this piece of machinery. There are many places that loose clothing may become wrapped or pulled into devices.
- Be aware of any moving parts on this machinery. Make sure that any person or persons on or around this piece of machinery are aware of the dangers as well. There are many places where injury may occur. Learn your unit and the dangers of it. Always use caution in the operation of this piece of machinery.
- Be sure that any individuals operating this equipment are trained and are aware of the dangers of this equipment.
- Check for rocks, sticks, or anything of solid mass that may cause bodily harm to or damage to your spreader.
- Never attempt to work on or repair this piece of equipment while it is running. All power sources must be completely disengaged while working on your spreader.
- Those working around this equipment should remain at least 100 feet from it while it is in operation. The fans are able to propel objects at a high speed up to this distance.
- Use extreme caution while operating this equipment. Its size may limit your field of vision.
- Never allow a leak of hydraulic fluid to persist. Hydraulic fluid is kept under very high pressure, and may cause serious injury if it hits the facial area, especially the eyes.
- Shut down the entire system before checking hydraulic fluid level or adding fluid to the system.

OPERATION

**TEST YOUR
SPREADER
BEFORE
YOU LOAD
IT!**

**MINIMUM
OIL FLOW:
18 GPM**

**FLOW =
SPEED
PRESSURE =
STRENGTH**

TRACTOR REQUIREMENTS

Your tractor must have sufficient oil flow from the remote ports to operate the sand spreader.

An oil flow rate of at least 18-20 gallons per minute is recommended to properly operate the spreader.

If your spreader does not supply enough oil, BBI may be able to provide you with an alternative solution. Please contact our service department for assistance.

PLUG TO TRACTOR

1. Connect hydraulic hoses from spreader to tractor remote ports as shown below.
2. Adjust priority valves to desired settings.

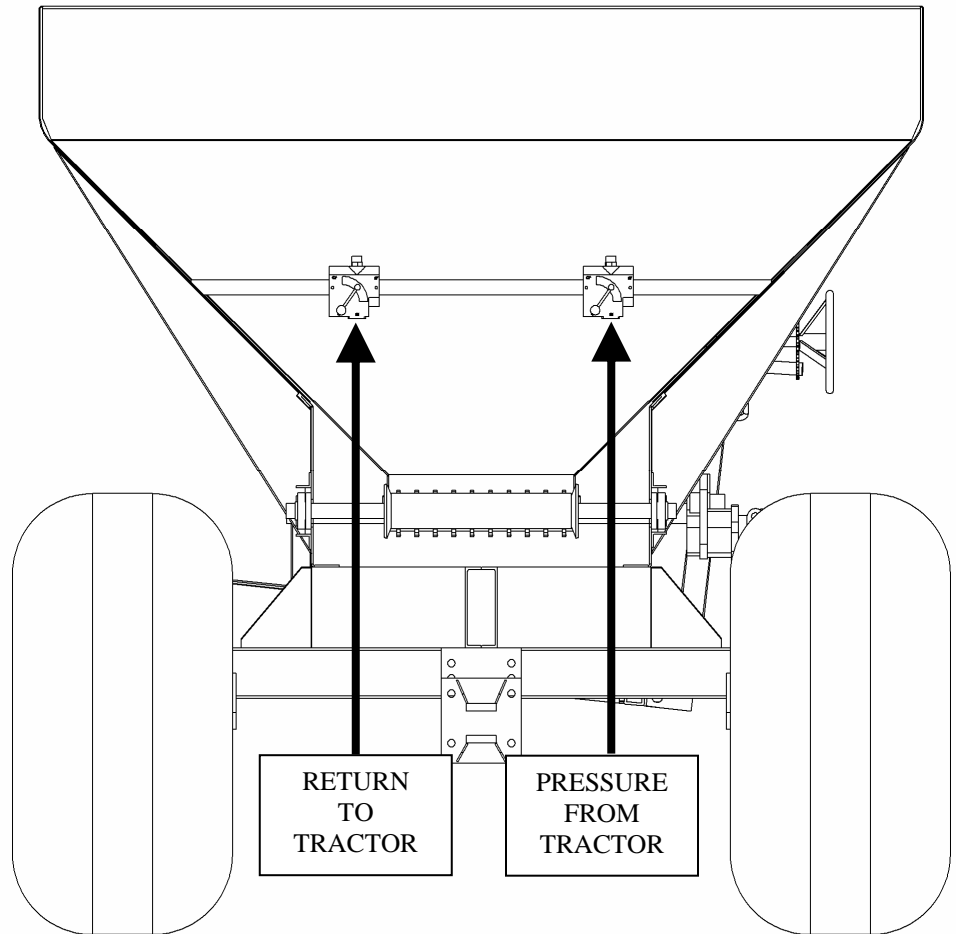

HYDRAULIC SYSTEM

The hydraulic system is designed to be run by your tractor's remote ports. The system consists of two motors, (one to drive the bed chain and one to drive the side conveyor) each with an independent flow control valve to vary the speed. The system runs in series with a maximum pressure of 2000 psi. See the illustration on the next page.

HYDRAULIC SYSTEM

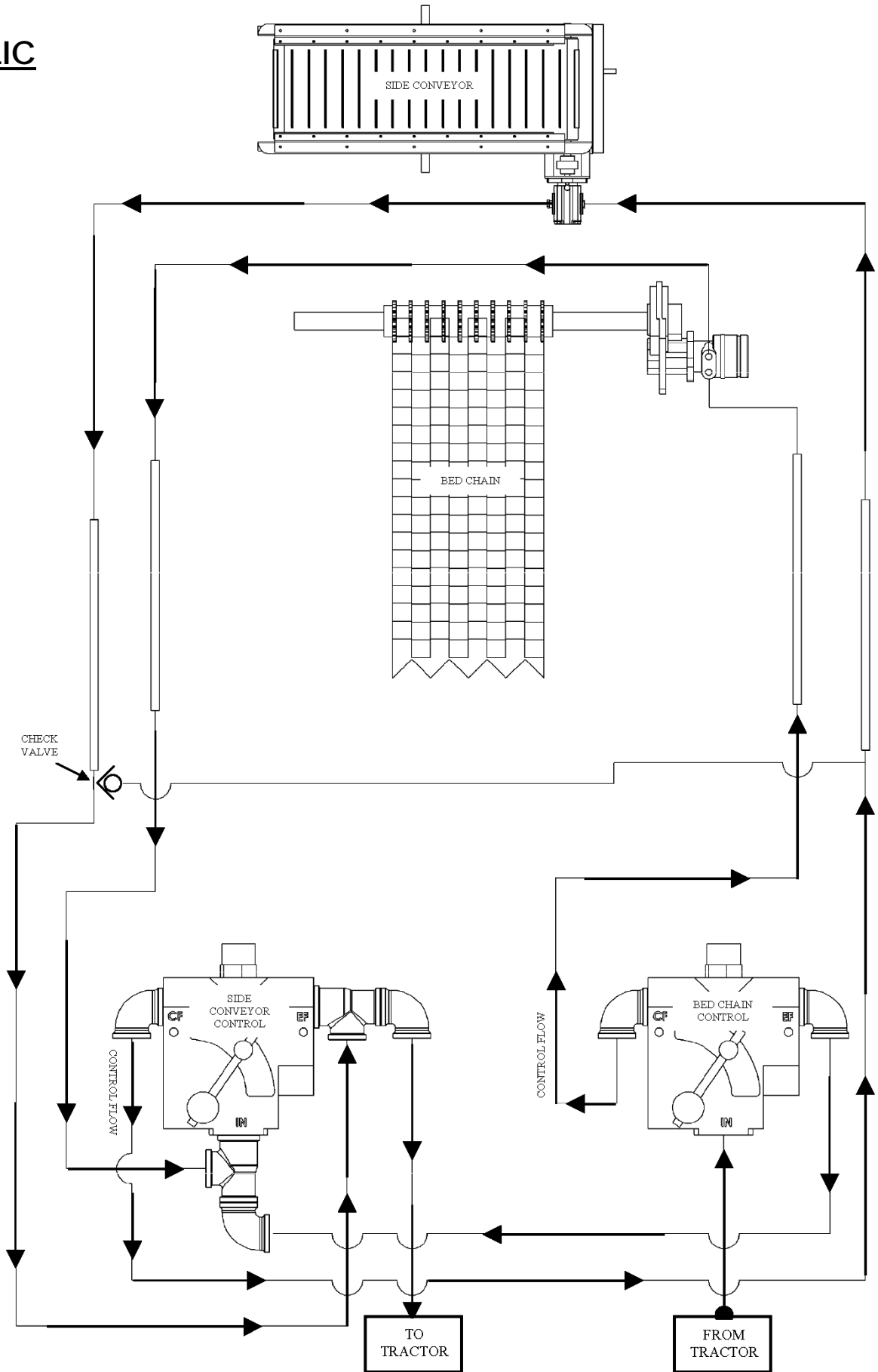

HYDRAULIC CONTROLS

PRIORITY FLOW CONTROL VALVES

The priority valves, located on the front of the spreader, *cannot* be set at the factory.

You must adjust the levers to control the oil flow to both conveyors for your tractor and application rate desired.

BED CHAIN CONTROL

Located on the driver side, it controls the speed of the stainless steel bed chain. Along with the gate height, this controls the amount of material being applied.

SIDE CONVEYOR CONTROL

Located on the passenger side, it controls the speed of the rubber side conveyor. The speed and position of the side conveyor changes how material is applied and the distance it is thrown.

Relief Valves

Both priority valves have relief valves built in. The relief valves are preset to 2000 psi at the factory.

All hydraulic components are rated at a maximum of 2000 psi.

**MAXIMUM PRESSURE:
2000 PSI**

SIDE CONVEYOR FLOW CONTROL VALVE

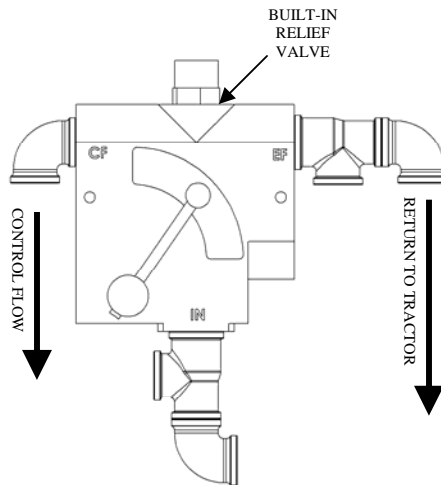

PASSENGER SIDE

BED CHAIN FLOW CONTROL VALVE

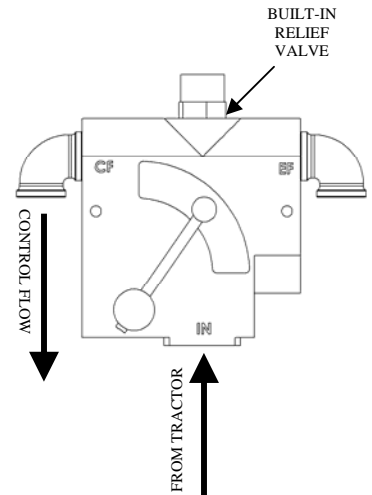

DRIVER SIDE

SIDE CONVEYOR

ADJUSTMENT

Using the jack, you can tilt the conveyor up or down to change the trajectory of the material by over 20 degrees. Adjusting the speed and position of the conveyor allows you to change how the material is applied and the distance it is thrown.

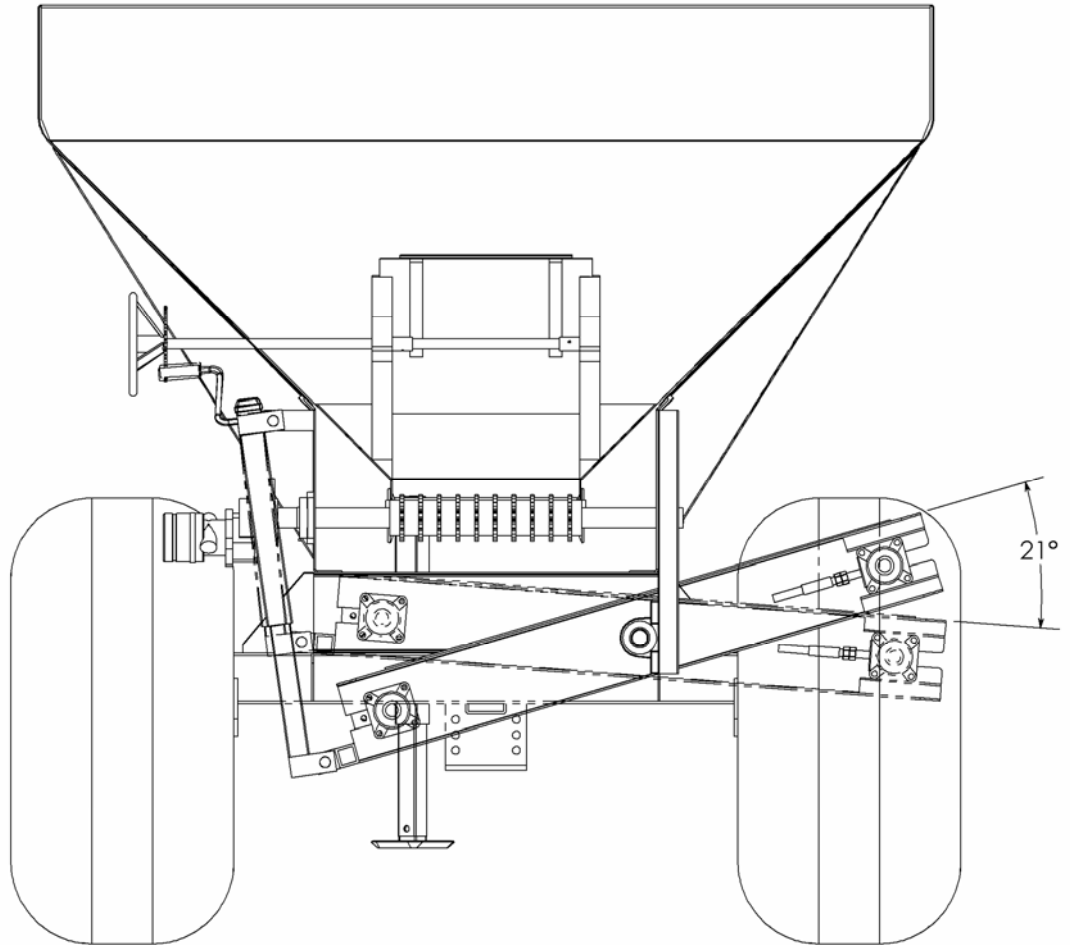

MAINTENANCE

GREASE POINTS

1. Front Roller Bearings (2)
2. Rear Roller Bearings (2)
3. Side Conveyor Bearings (4)
4. Gate Rod Collars (3)

LUBRICATION

Keeping components clean and lubricated can make a major impact on their longevity.



Bearings should be lubricated with #2 Lithium Base grease formulated from high quality mineral oil with rust and oxidation inhibitors. Pump the grease slowly until it forms a slight bead around the seals to provide additional protection against the dirt.

Refer to the diagram below for most grease points on your spreader.

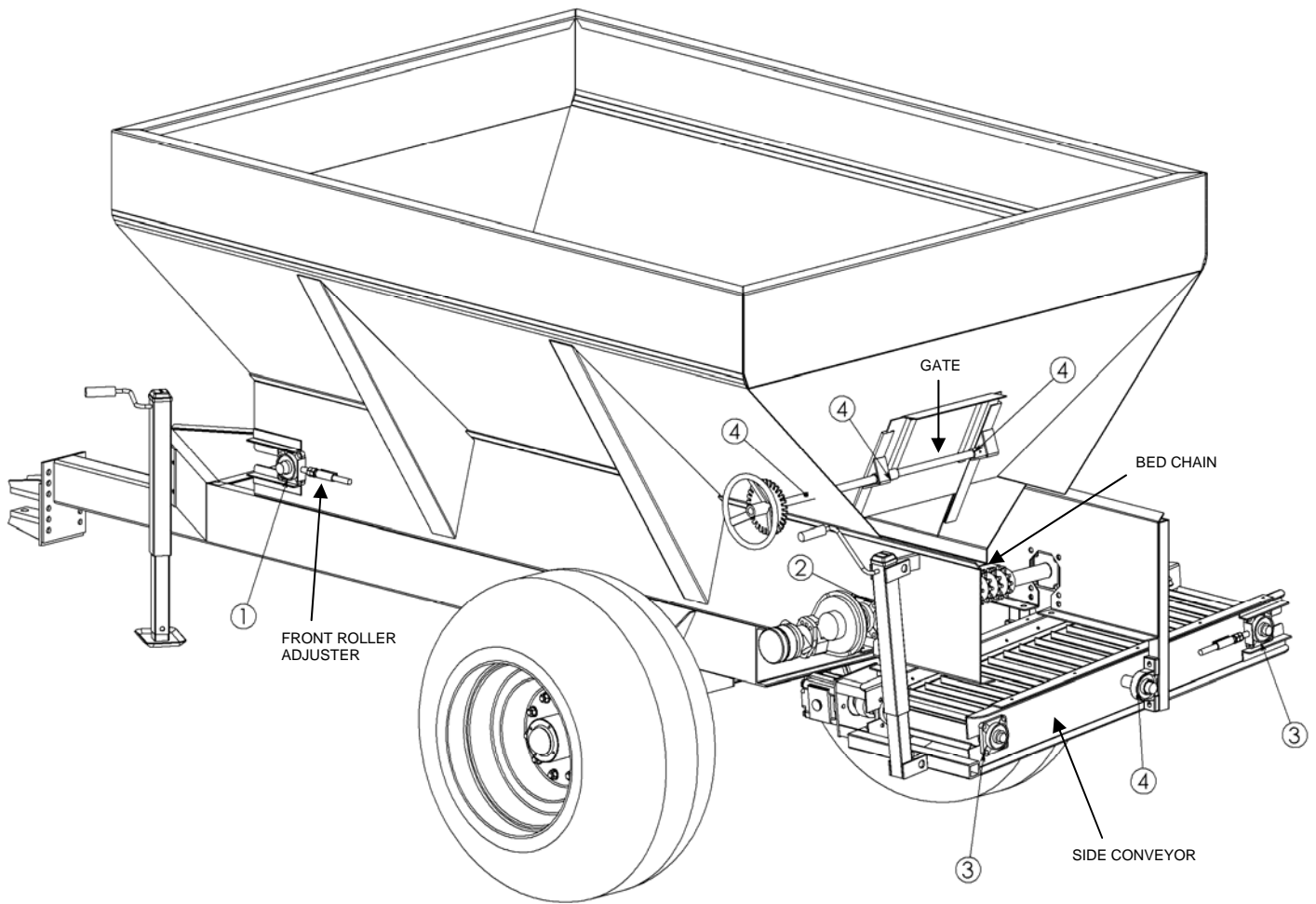

CHECK LUG NUTS DAILY

FASTENERS

Tighten all fasteners after the first week of operation. Periodically inspect fasteners any time they are loose. Replace any lost or damaged fasteners or other parts immediately upon finding such damage or loss.

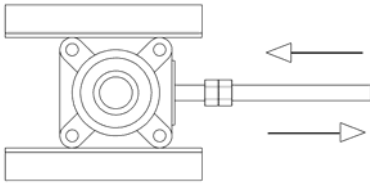

Front Roller Adjustment

CONVEYOR BED CHAIN

It is very important to have the proper tension on your bed chain. Be sure the chain is tightened equally on both sides. The adjustment is made on each side of the unit at the idler bearings located at the front of the unit.

Chains that are too tight will cause the rollers to break.

See the illustration below for correct chain tension.

CORRECT

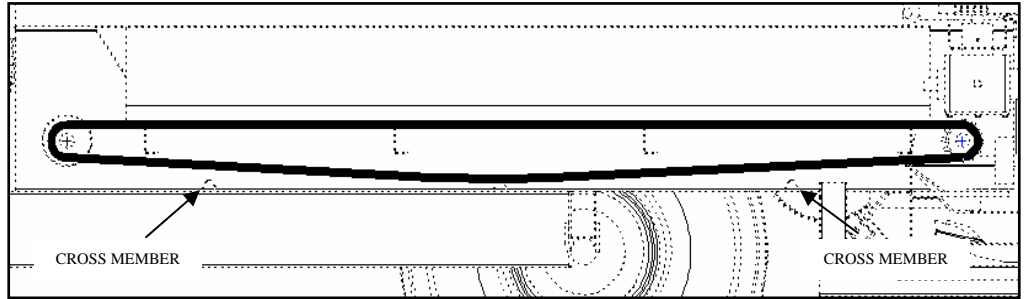

TOO LOOSE

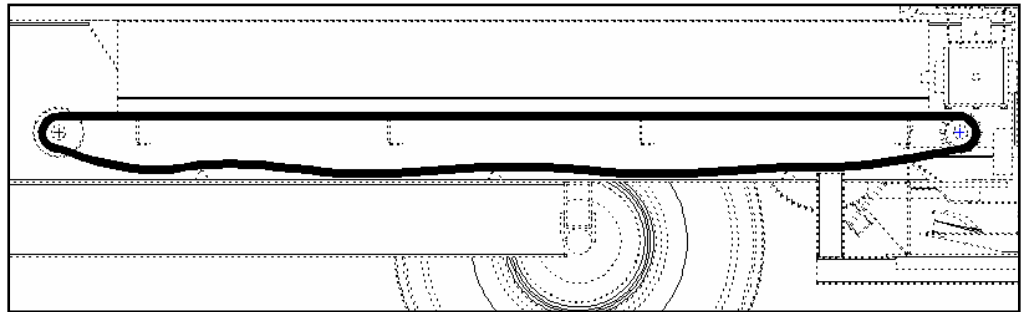

TOO TIGHT

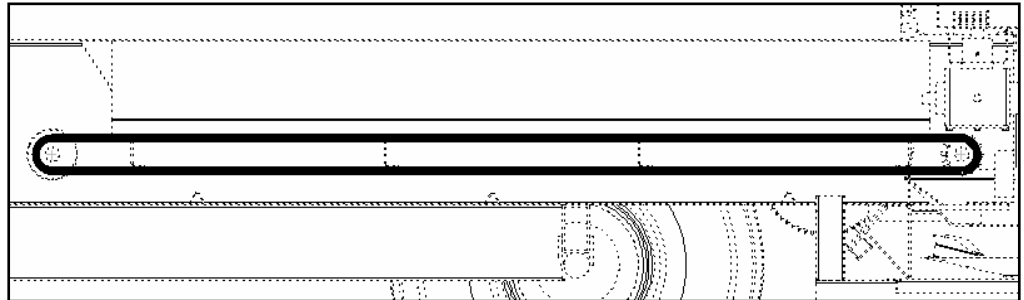

**A TIGHT BED
CHAIN WILL
BREAK YOUR
ROLLERS**

The bottom of the chain should have just enough tension to keep it off the first and last cross member.

Stainless steel mesh chain will stretch when first used. Chain must be checked for appropriate tension and properly adjusted to avoid damaging unit. After initial break in period, stretching should be minimal.